

ModuDesk Modular Table Series

Instructions.

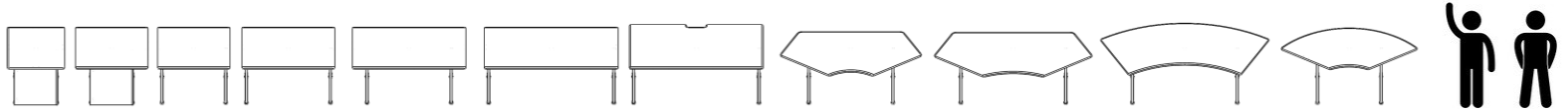
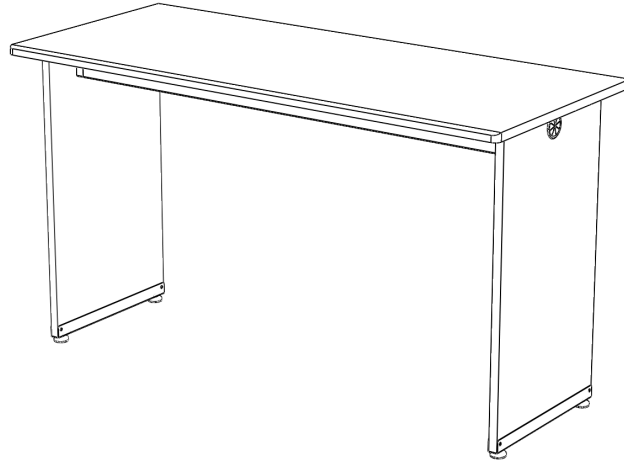

Sections

Instructions Summary:

1. Fasteners.
2. Accessories.
3. Assembly.

Tools you will need:

1. Philips Head Driver – PH2



2. 5mm & 4mm Allen Key



3. Drill (Recommended)



4. Hammer



ModuDesk Modular Table Series

Part Check List Per Unit (Items Labeled)

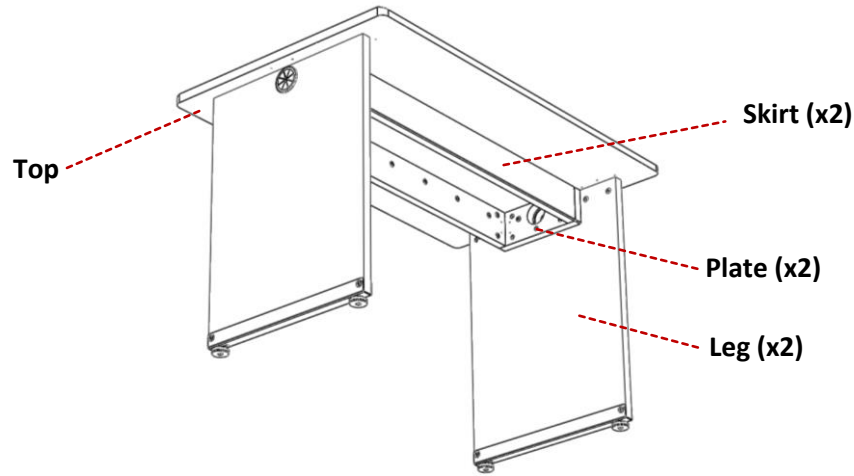

	A	B	C	D	E	F	G	H	I
1	MODUDESK CHECKLIST								
2	Configuration Equation								
3		TOP	SKIRT x2	LEG x2	PLATES	ADD-ONS	ADD-ONS	ADD-ONS	ADD-ONS
4	MOD2928-A	AJ	A	29 10U	2	10U RACKS	29 DOORS		
5	MOD2935-B	BK	A	29 10U	2	10U RACKS	29 DOORS		
6	MOD2935-C	CL	B	29 BASIC	2	-			
7	MOD2945-D	DM	B	29 BASIC	2	-			
8	MOD2945-E	EN	C	29 BASIC	2	-			
9	MOD2955-F	FO	C	29 BASIC	2	-			
10	MOD2955-G	GP	D	29 BASIC	2	-			
11	MOD2965-H	HQ	E	29 BASIC	2	-			
12	MOD2965-I	IR	E	29 BASIC	2	-			
13	MOD2928-J	AJ	A	37 14U	2	14U RACKS	37 DOORS		
14	MOD2935-K	BK	A	37 14U	2	14U RACKS	37 DOORS		
15	MOD2935-L	CL	B	37 BASIC	2	-			
16	MOD2945-M	DM	B	37 BASIC	2	-			
17	MOD2945-N	EN	C	37 BASIC	2	-			
18	MOD2955-O	FO	C	37 BASIC	2	-			
19	MOD2955-P	GP	D	37 BASIC	2	-			
20	MOD2965-Q	HQ	E	37 BASIC	2	-			
21	MOD2965-R	IR	E	37 BASIC	2	-			
22	MOD2969-S	SV	C	29 BASIC	2	-			
23	MOD2977-T	TU	D	29 BASIC	2	-			
24	MOD2977-U	TU	D	37 BASIC	2	-			
25	MOD2969-V	SV	C	37 BASIC	2	-			
26	MOD2966-W	WY	C	29 BASIC	2	-			
27	MOD2982-X	XZ	D	29 BASIC	2	-			
28	MOD2966-Y	WY	C	37 BASIC	2	-			
29	MOD2982-Z	XZ	D	37 BASIC	2	-			
30	MOD2965-00	IR	A + A	29 10U	4	10U RACKS	29 DOORS		
31	MOD2965-01	HQ	C + A	(1) 29 BASIC + (2) 29 10U	4	10U RACKS	MODU-P2	MOD-LS	29 DOORS
32	MOD2956-02	56-02	-	29 BASIC	-	-			
33									
34	MODU-P1								
35	MODU-P2								
36	MODU-P3								
37	MODU-P4								
38									
39	MOD-LS					X4 CORNER BRACKETS			
40	MOD-CC			WIRE COVER LEGS		X4 OVERLAY HINGES			
41	MOD-SC					X4 MOUNTING PLATES			
42	MOD-RC					X4 MOUNTING PLATES			
43	MODU-EXT					X4 BLIND CORNER HINGES			

ModuDesk Modular Table Series

- 1 Fasteners:**
Standard ModuDesk
 X34 Metal Dowel Pins
 X34 20mm Cams
 X12 Wooden Dowels
 X10 8x 1.5" Wood screws
 X16 8x 0.75" Pan Head Screws (+4 for Mounting Plates)
 X4 JCN ¼-20x17mm Bolt
 X4 JCN ¼-20x17mm Cap

Optional Modesty Panel: ModuP1-4 (only P4 gets extra bracket)

- X6 (+3 for extra bracket) 8x 1" Wood Screw
 X6 (+3 for extra bracket) 8x 0.75" Pan Head

Optional ModuDesk Rack (29 or 37)

- X2 Rack Doors
 X4 Blum Hinge (Standard)
 X2 Door Extensions + x4 Blind Corner Hinge (Optional)
 X4 Rack Rails: 10U (for 29) or 14U (for 37)
 X2 Door Locks with Keys

Optional Cable Cover: MOD-CC

- X2 Slim Doors
 X2 Blum Hinge (Standard)

Optional Lower Shelf: MOD-LS

- X1 Shelf
 X4 Small L-Brackets
 X4 8x 0.75" Pan Head Screw

Optional Round Corner: MOD-RC

- X1 Round Corner Panel
 X16 8x1" Pan head Screw

Optional Square Corner: MOD-SC

- X1 Square Corner Panel
 X16 8x1" Pan head Screw

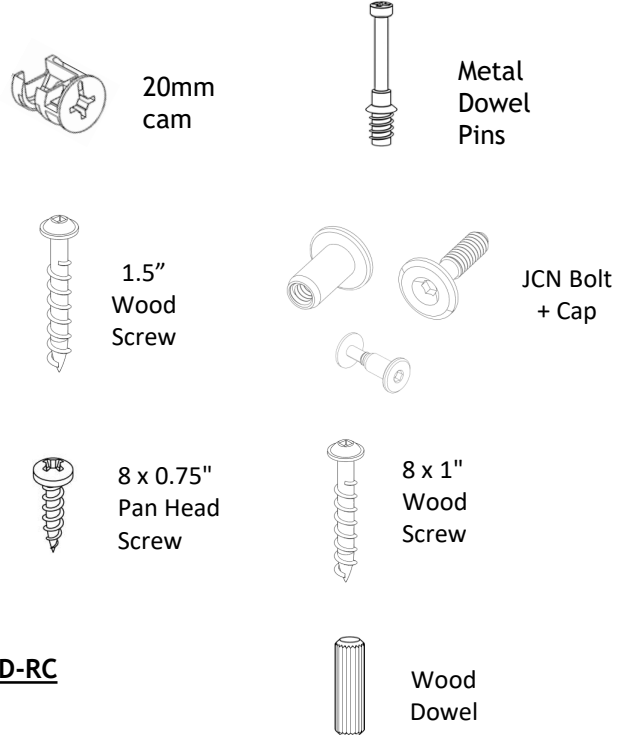

2 Hardware:

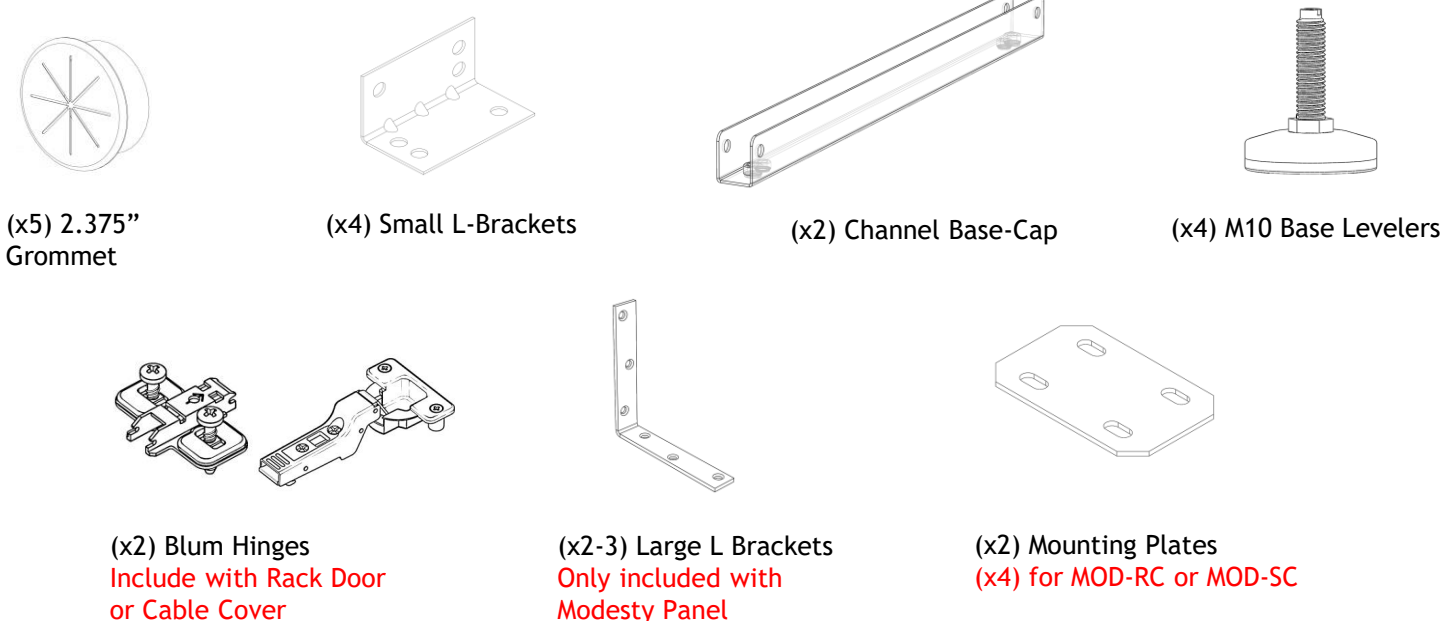

ModuDesk Modular Table Series

3

STEP 1

- Use Power Drill to screw in Metal Dowel Pins into small holes.
- Screw Metal Dowels in ALL Holes of the exact same size on ALL panel faces
- Wood Dowel can be pressed or hammered in. Place in all holes of the exact size.

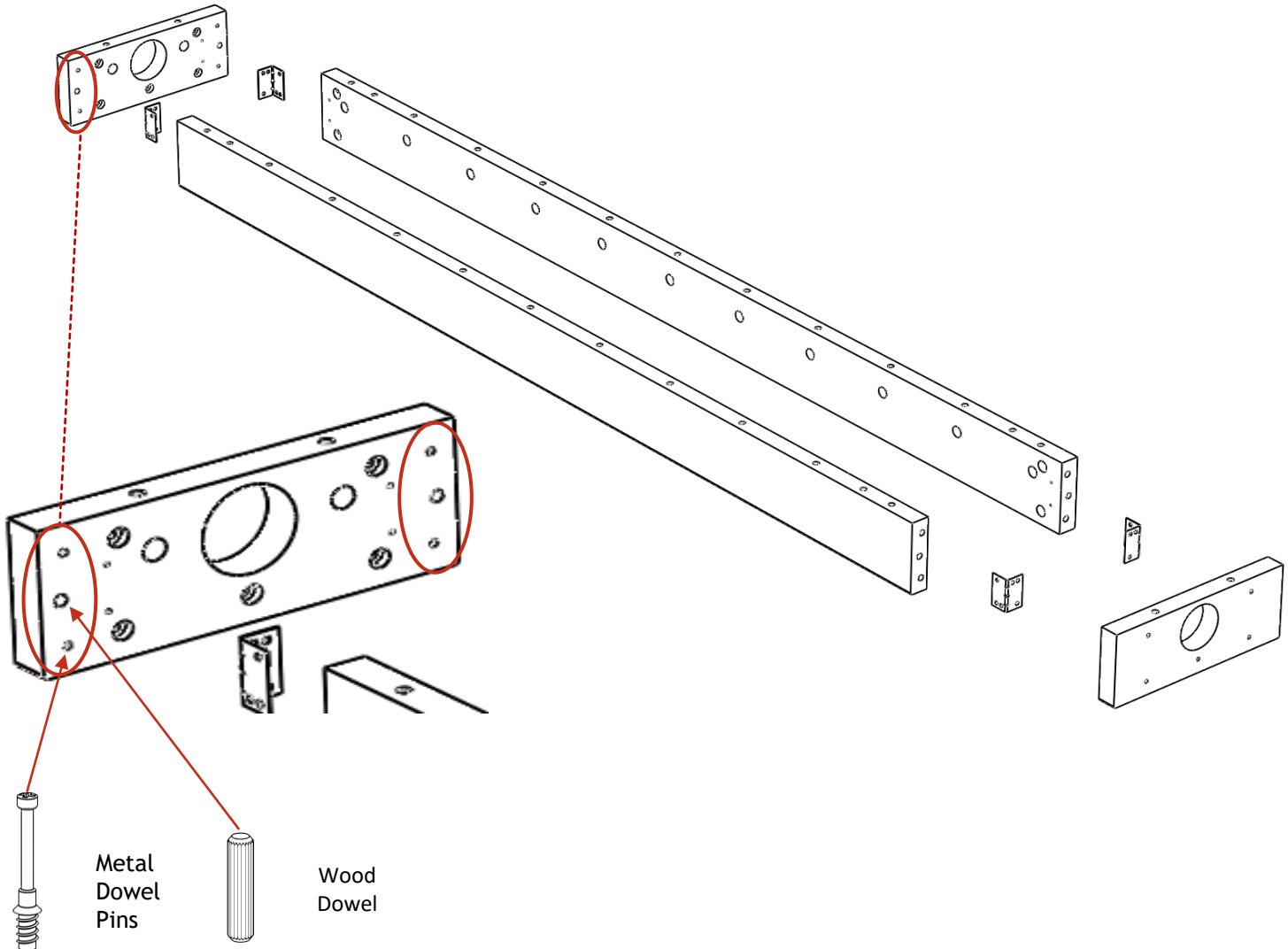
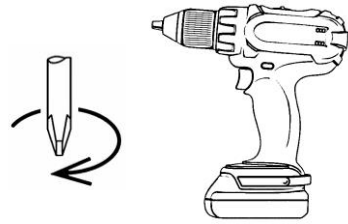

ModuDesk Modular Table Series

3

STEP 2

- Insert 20mm Cam into ALL holes of the same size on ALL panels
- Fasten panels together to create a Frame using Metal Dowel Pins and 20mm Cams
- Use 8x.75" Pan Head Screw to fasten x4 L-Brackets for extra strength

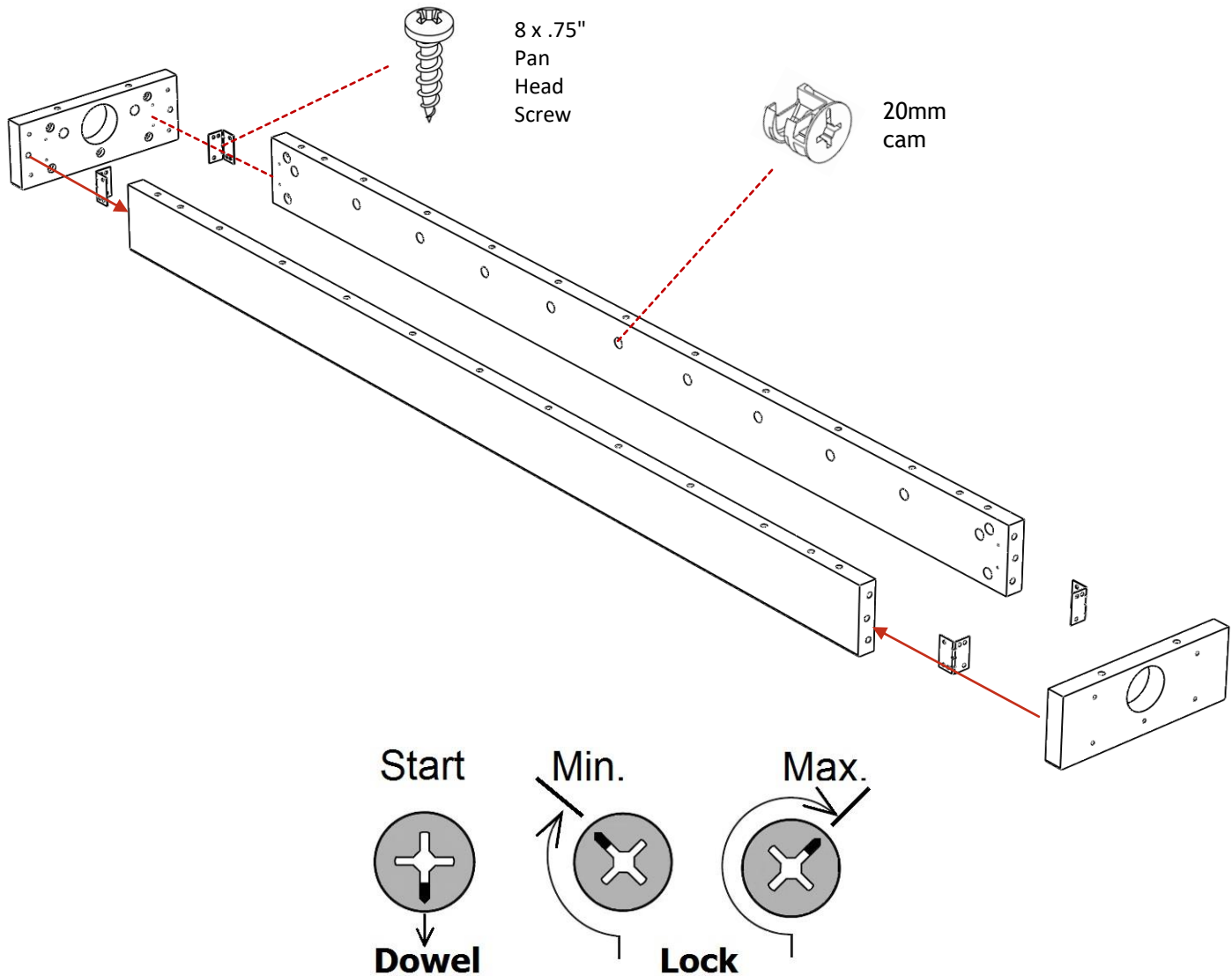
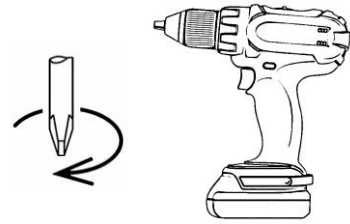

Point Arrow on Cams toward the exit of the hole.
This will allow for the Dowel pins to insert into them.

ModuDesk Modular Table Series

3

STEP 3

- Use Power Drill to screw in Metal Dowel Pins into small holes.
- Once dowelled, combine Frame with the underside of the Tabletop

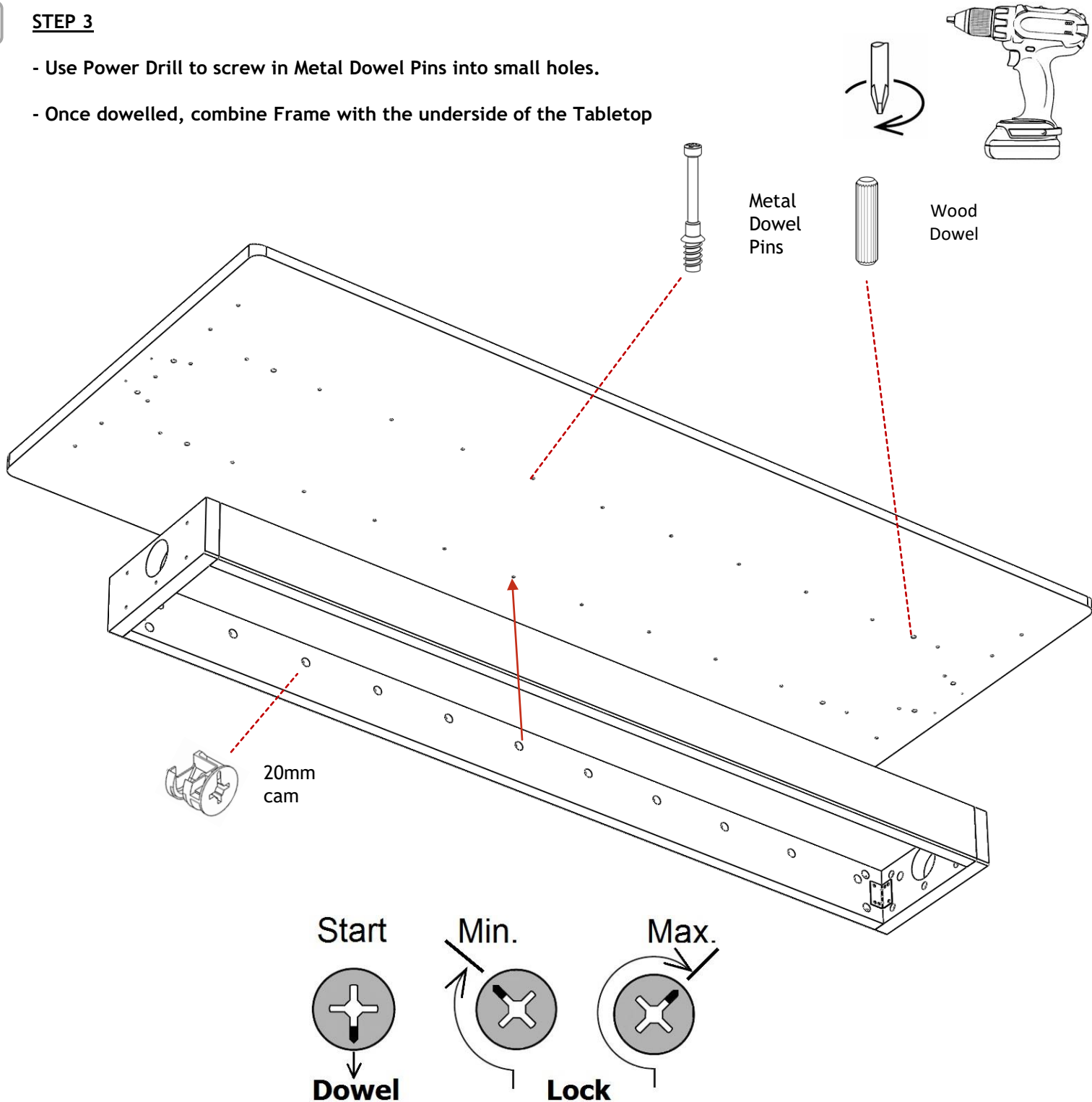

Point Arrow on Cams toward the exit of the hole.
This will allow for the Dowel pins to insert into them.

ModuDesk Modular Table Series

3

STEP 4

- How to connect tables

Connect tables using Mount Plates before attaching legs

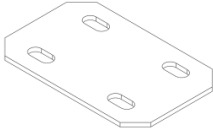

Mounting Plate



8 x .75" Pan Head Screw

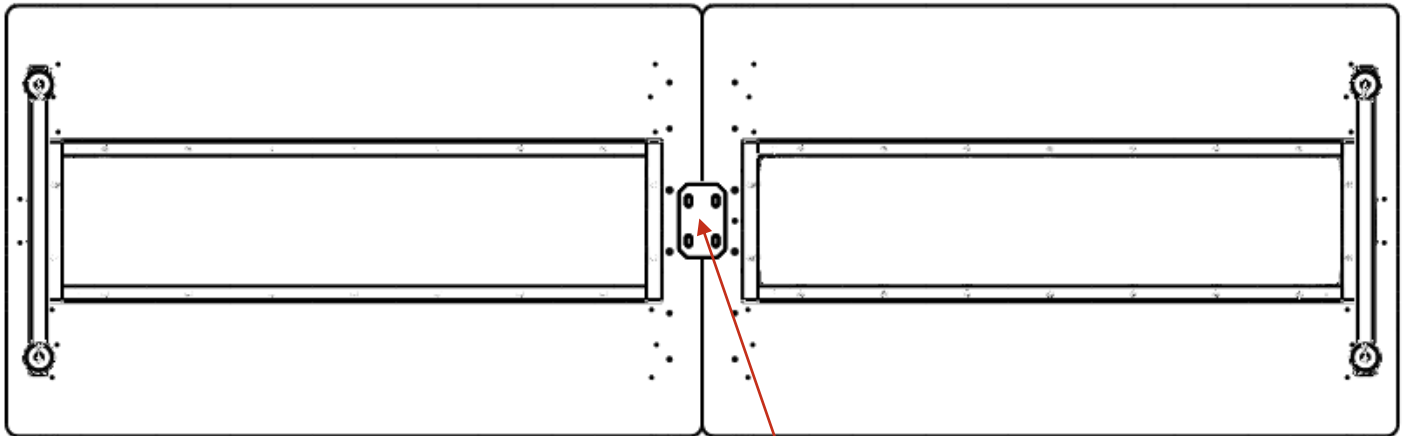
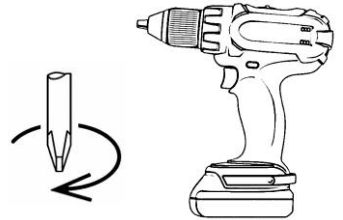

Mounting Plate

ModuDesk Modular Table Series

3

STEP 4

For MOD-CC (Cable Cover):

To insert both Hinge and Plates, Hammer and fasten them into the locations using the screws that arrive with the hinges.

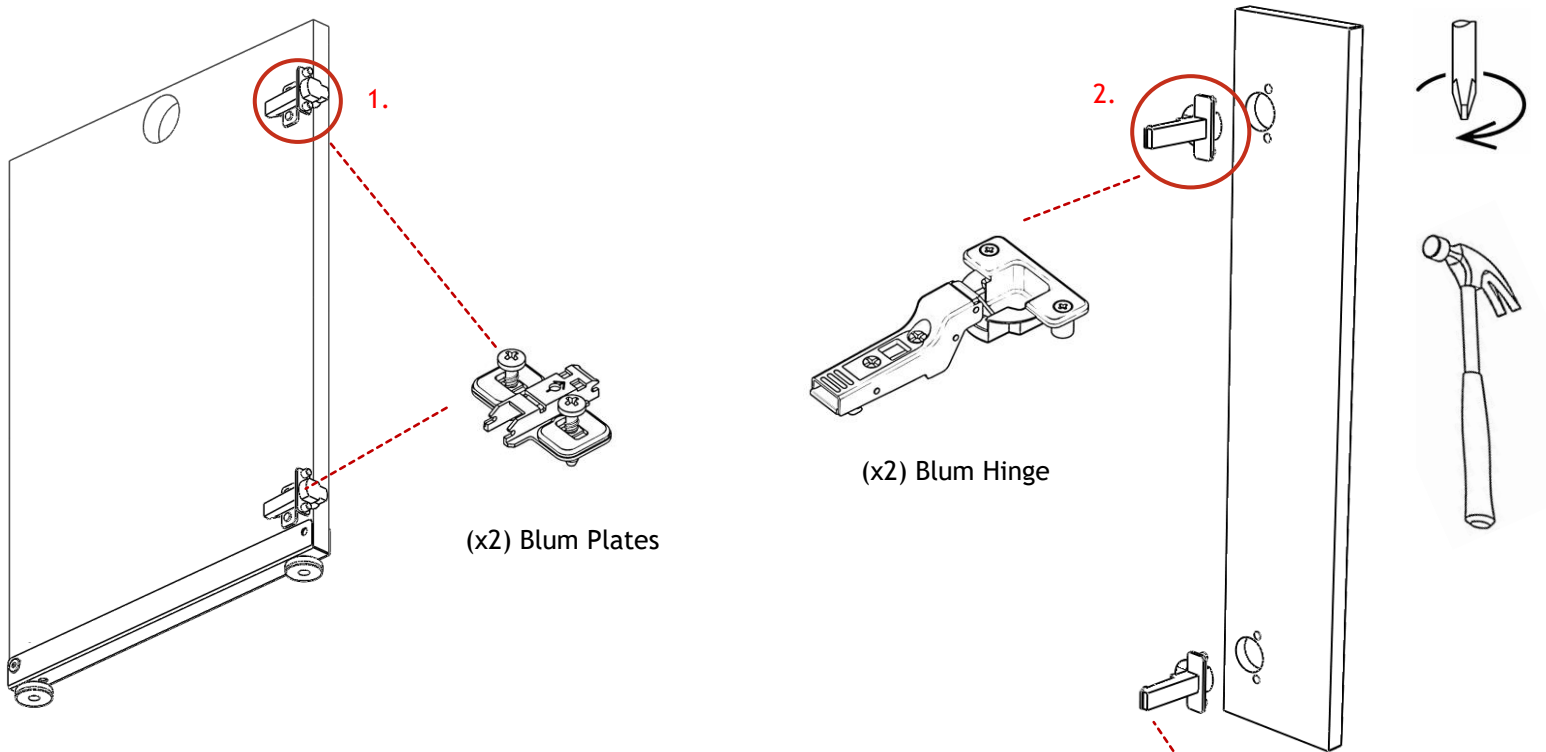

3. To attach Hinge + Plates, simply clip them together, no special tools required.

4.

Three-dimensional adjustment

Side adjustment

Turn front screw to increase or decrease door overlay (+/-2mm).

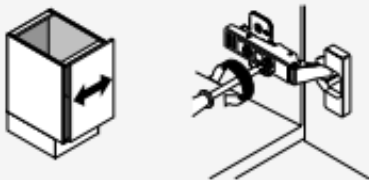

Height adjustment

Rotate cam Screw-on mounting plate to adjust door position (+/-2mm).



On non-cam mounting plates, loosen screw, adjust door and retighten screws.

Depth adjustment

Turn rear spiral-tech cam screw to adjust door position (+3mm, -2mm).



For CLIP, loosen rear screw, adjust and retighten.

ModuDesk Modular Table Series

3

STEP 4

- Screw in Dowels, Place Cams, and Combine Panels
- Screw in x5 1.5" Wood Screws per side for extra strength

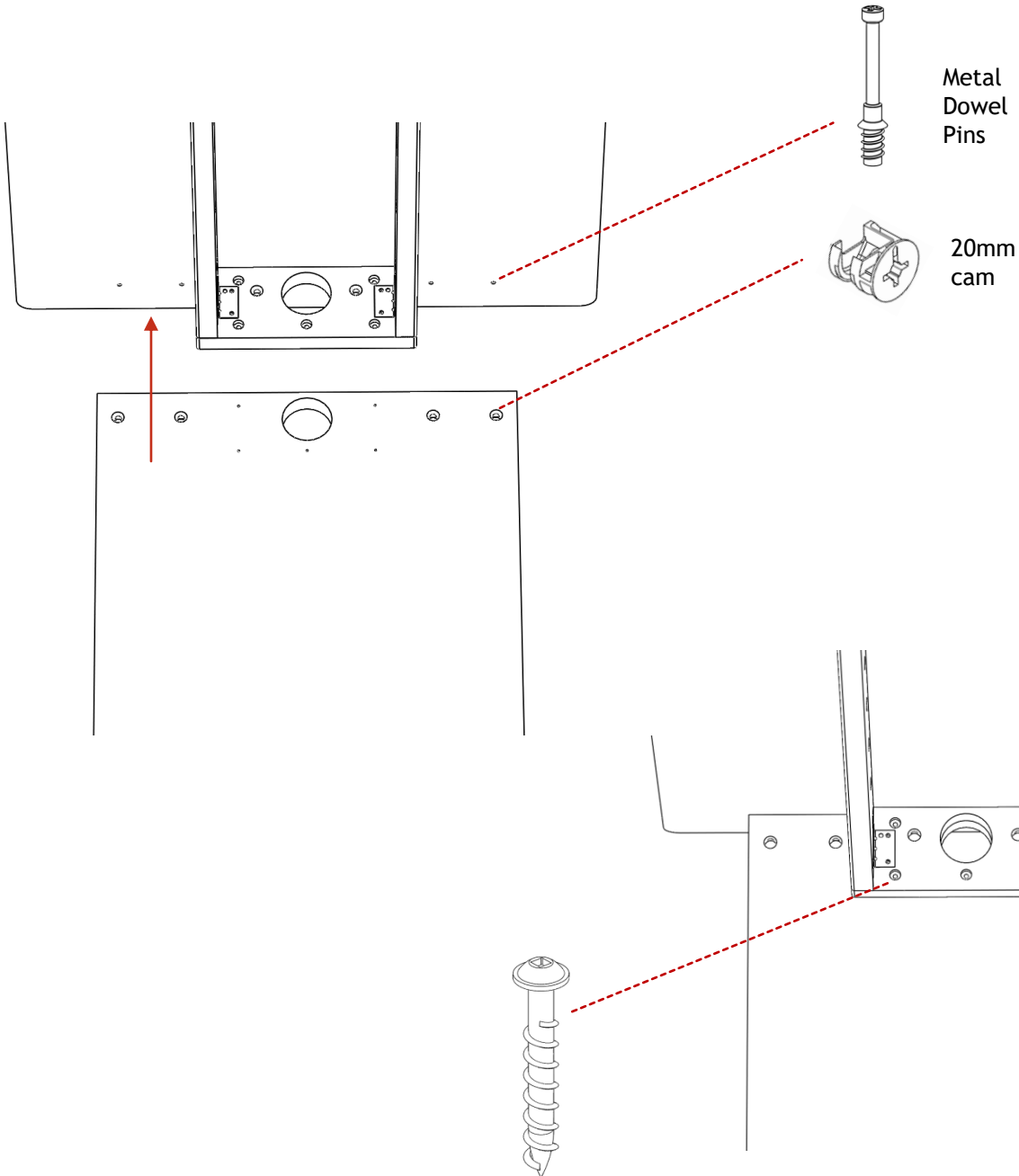
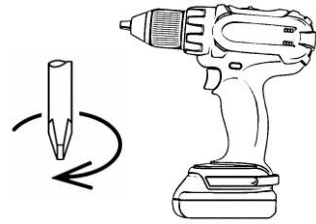

1.5" Wood Screw

ModuDesk Modular Table Series

3

STEP 4

- Depending on chosen base, screw in Levelers or Caster Stems into Extrusion (Casters will pop on with force)
- Fasten the JCN Bolt and Cap together, through the extrusion and panel, securing everything in place.

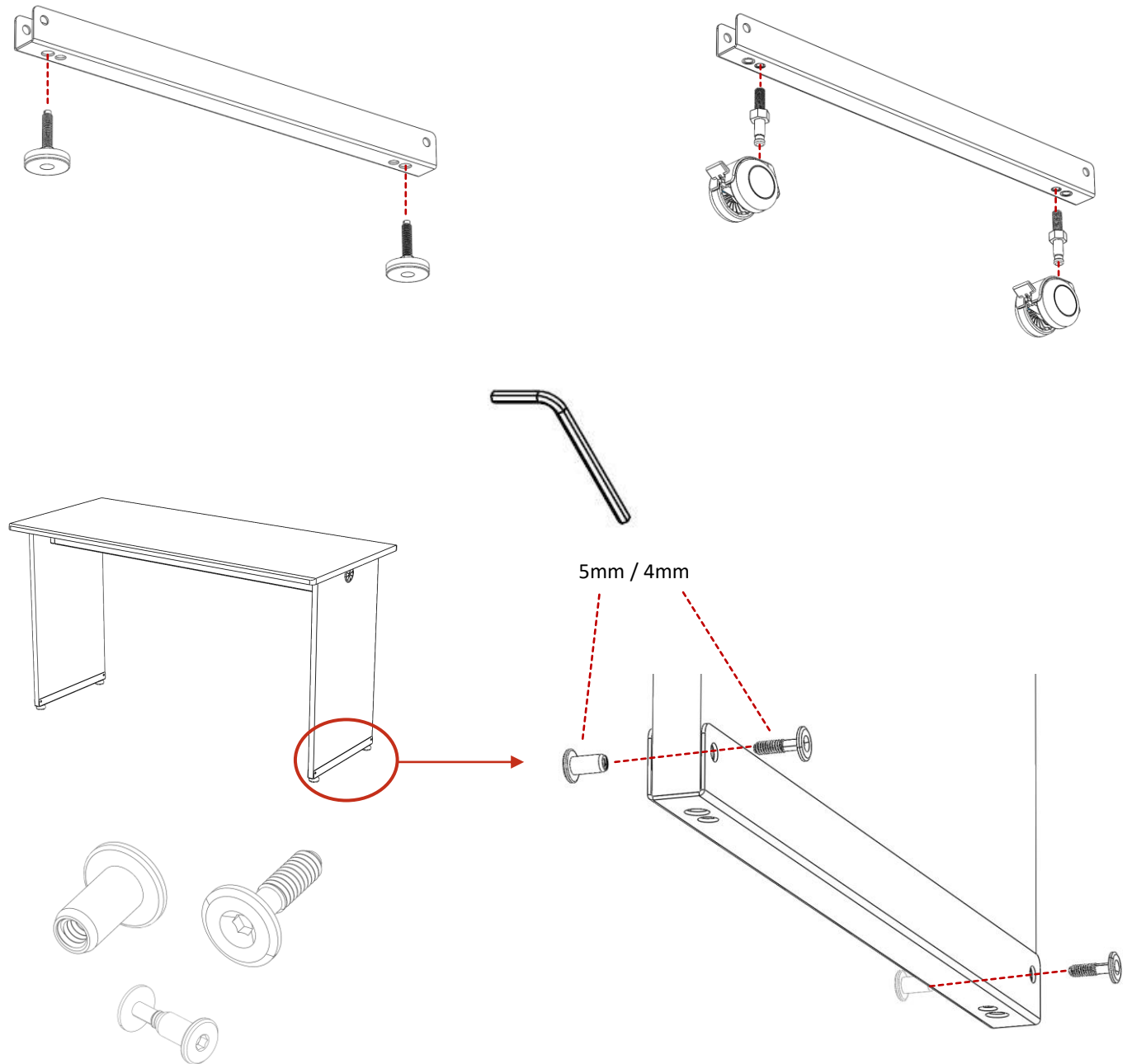

JCN Bolt + Cap

ModuDesk Modular Table Series

3

STEP 4

- IMPORTANT use 8x.75" Pan Head Screw to mount L-Bracket onto Modesty Panel



8 x .75"
Pan
Head
Screw

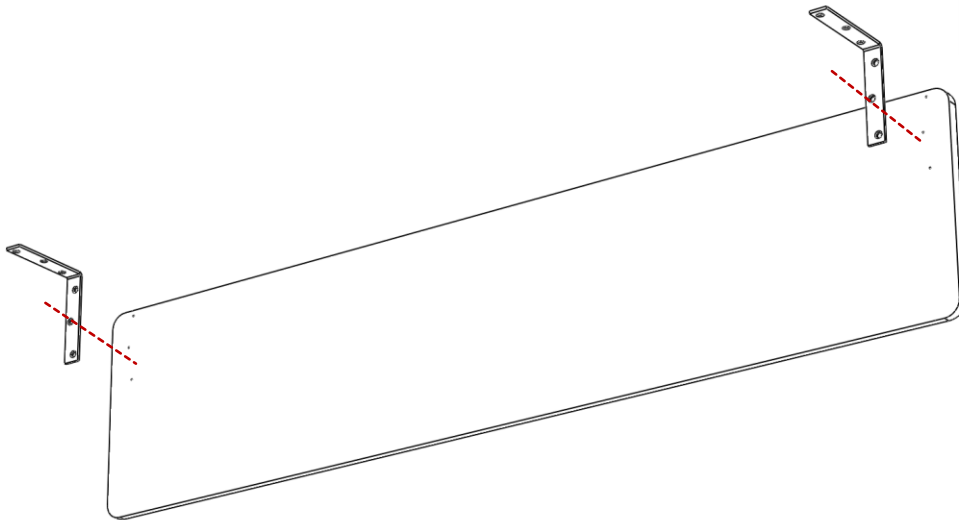

- IMPORTANT use 8x1" Pan Head Screw to mount L-Bracket onto Modesty Panel

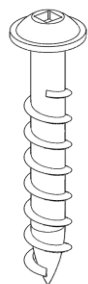

8 x 1" Pan
Head Screw

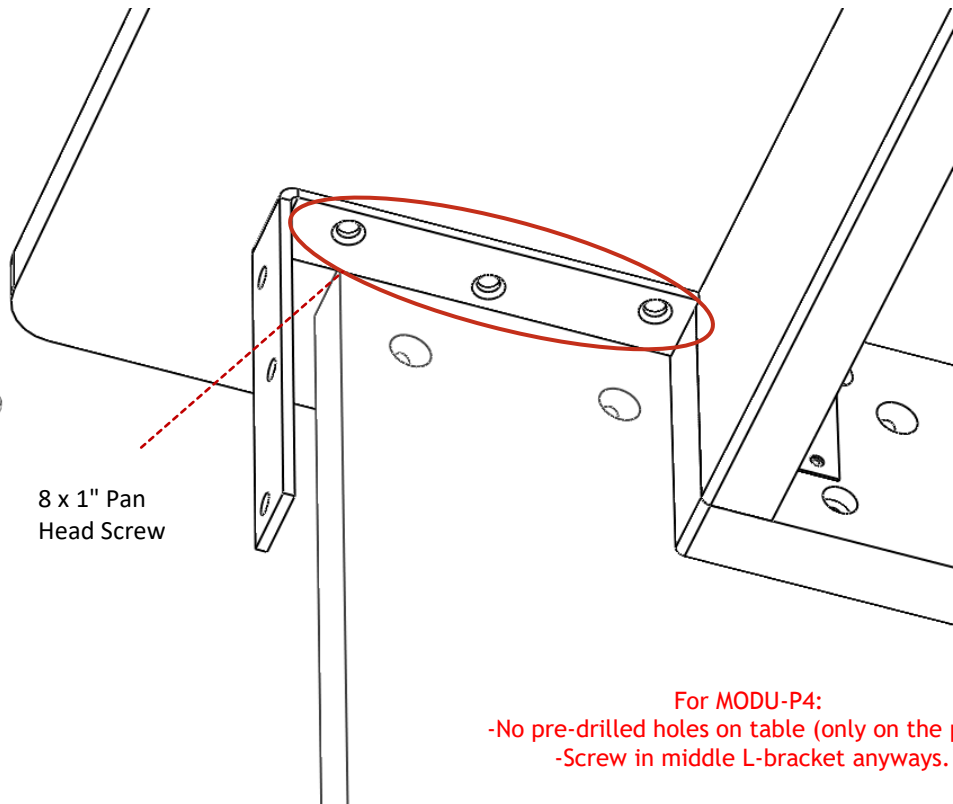

- For MODU-P4:**
- No pre-drilled holes on table (only on the panel)
 - Screw in middle L-bracket anyways.

ModuDesk Modular Table Series

3

For MOD-RC or MOD-SC

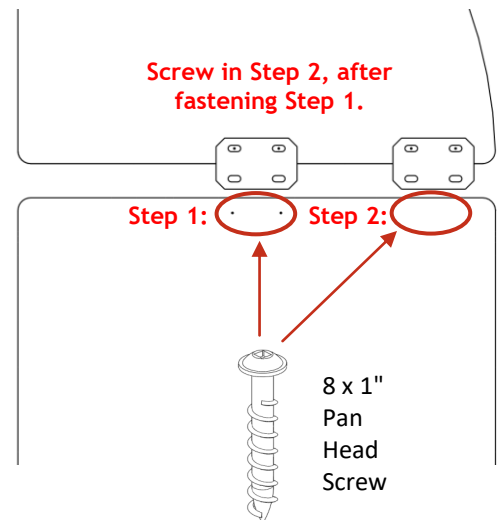
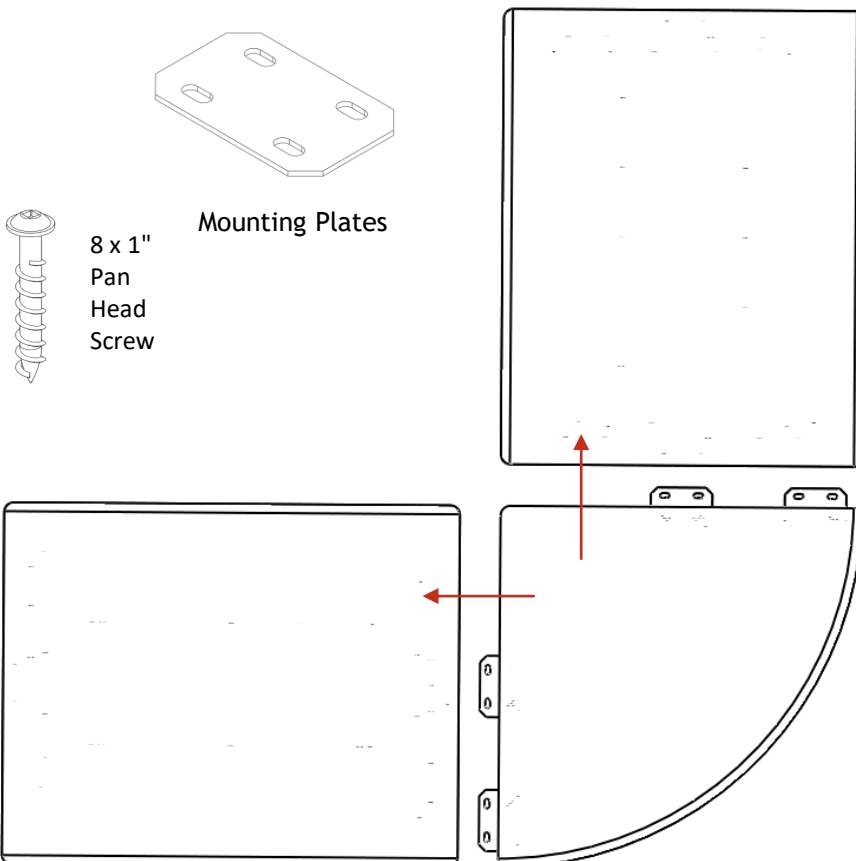
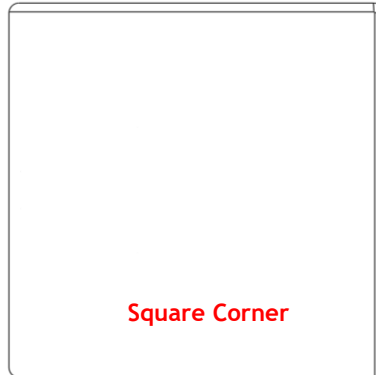
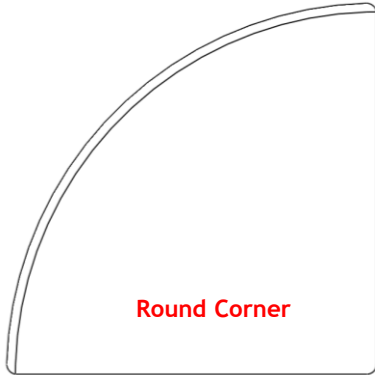
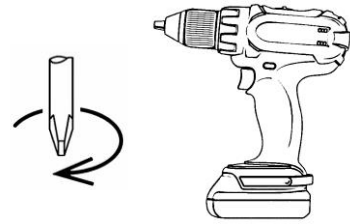

There will be no pre-drilled holes in step 2 location, screw in anyways.

ModuDesk Modular Table Series

3

STEP 4

- Complete!

